

SHEET TITLE

**CONSTRUCTUION OF GOVERNMENT
POLYTECHNIC COLLEGE-PHASE-III)
UNDER NABARD-RIDF-XX**

NORTH

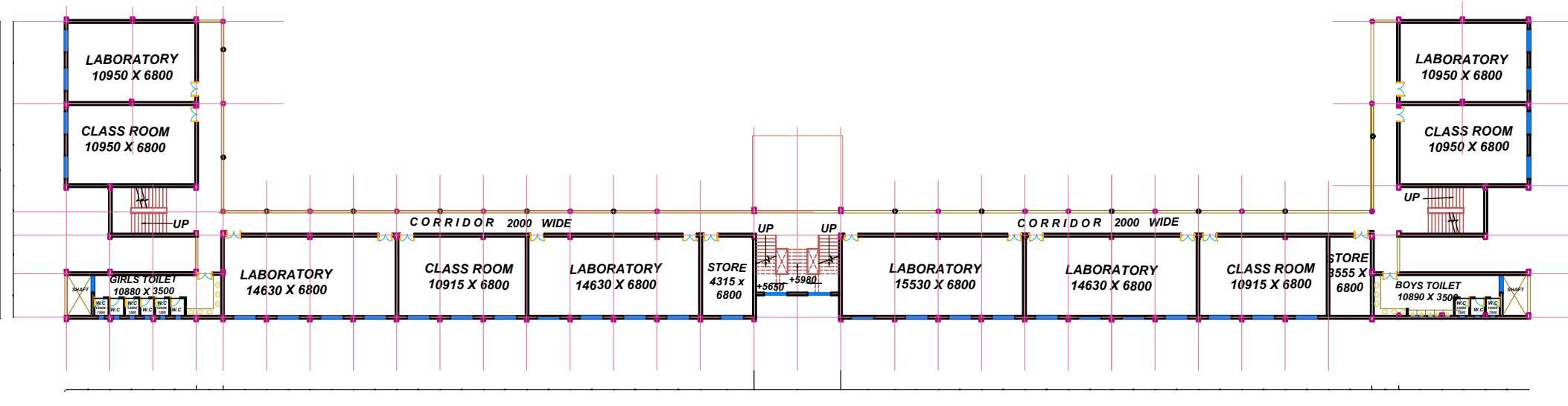
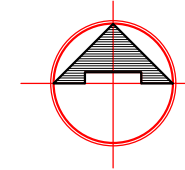

FIRST FLOOR PLAN

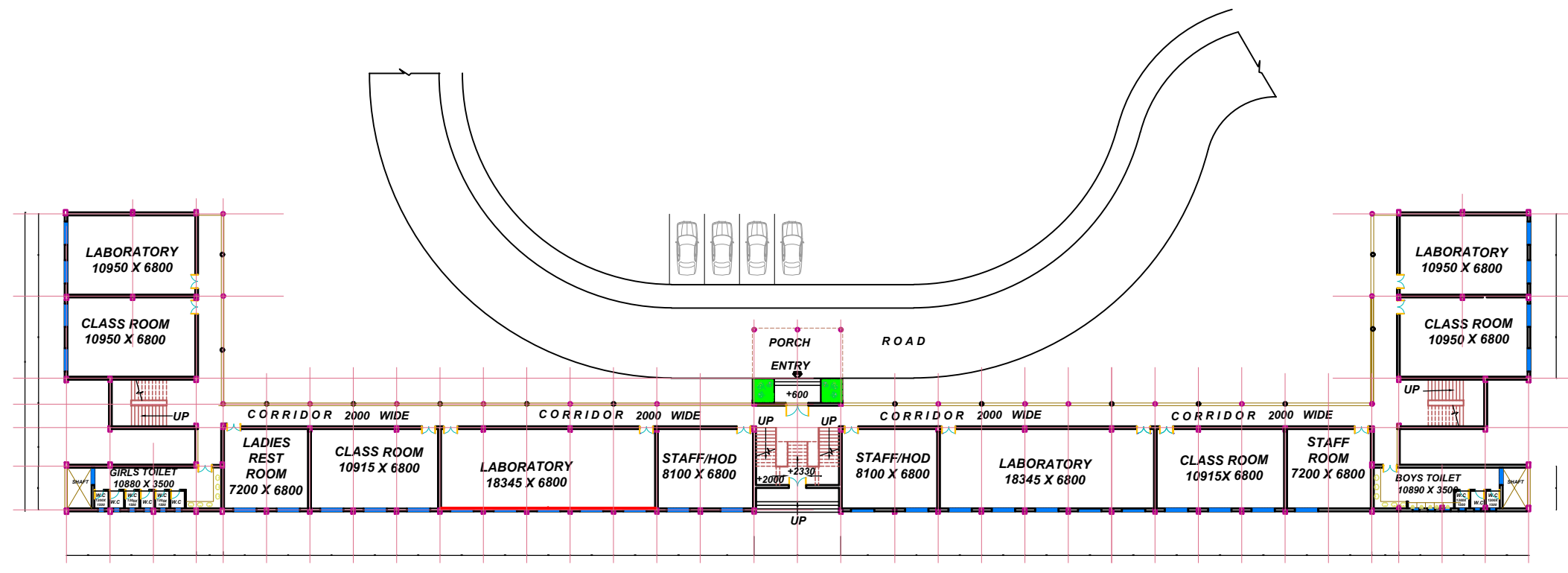

GROUND FLOOR PLAN

AREA STATEMENT

| | |
|-------------------------------------|---|
| PLOT AREA | 5.00 Acres (20234.28 Sq.m) |
| PLINTH AREA OF GROUND FLOOR | 1463.35 Sq.m |
| BUILT UP AREA OF FIRST FLOOR | 1463.35 Sq.m |
| S.FLOOR HEAD ROOM AREA | 58.29 Sq.m |
| TOTAL AREA | 2926.70 Sq.m |
| PORTICO AREA | 41.36 Sq.m |

**ANDHRA PRADESH EDUCATION &
WELFARE INFRASTRUCTURE
DEVELOPMENT CORPORATION**

**DRG.NO.1B/CE-APEWIDC/Polytechnic College
Ground & First floor plans**

// TRUE COPY//

**DY.EXECUTIVE ENGINEER (Design)
A.P.E.W.I.D.C HYDERABAD**

//Approved//

**Sd/-
COMMISSIONER OF TECHNICAL EDUCATION
GOVT. OF A.P. HYDERABAD**